



MADE FOR YOU:

INNOVATIONS @FATH

22 | FEB

FATH®

**INNOVATIONS
@FATH**

CONTENT

FATH inside

Get the flow

In conversation with: Till Zupancic



Engineering Components

Components Work Station

Conveyors

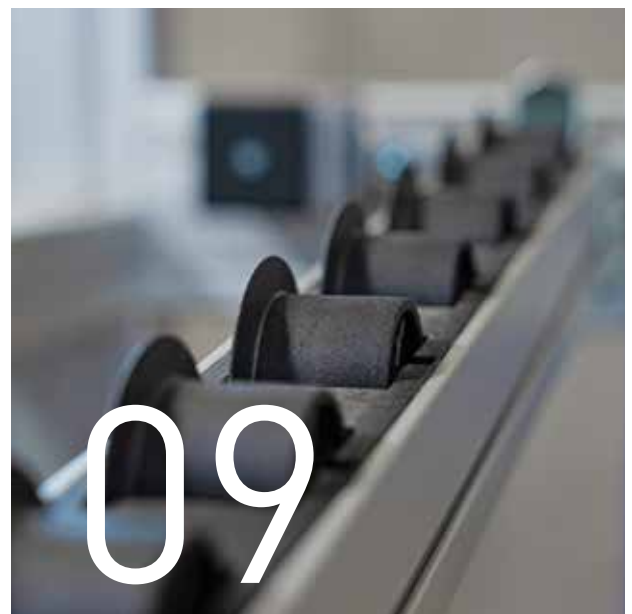



LEAN 4.0

Visual Management

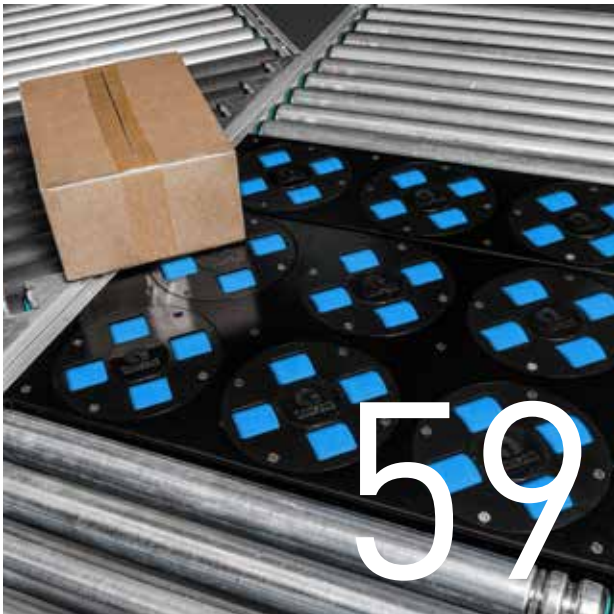

Warehouse and Intralogistic Automation

Flowsort® Sorting modules



Information

Part number index

Alphabetical index

GET THE flow

In conversation with: Till Zupancic

Director Corporate and Business Development **FATH** GmbH; Managing Director Flowsort BV

The Flowsort portfolio is aimed at intralogistics system integrators and conveyor builders. That is new. How does Flowsort fit into the FATH Ecosystem?

Till: Our goal is to offer customers around the world state-of-the-art solutions that bring more efficiency to industrial processes – **SOLUTIONS FOR INDUSTRIAL ECOSYSTEMS**. To achieve this, we take a close look at the markets and the prevailing environmental conditions. We have already achieved a great deal in this respect on the industrial shopfloor. Now we want to make our solutions accessible to other sectors as well. For us, Flowsort is the perfect entry into the rapidly growing intralogistics sector – and customers can benefit from the full range of the **FATH** Ecosystem.

The exciting thing is that several megatrends are currently emerging in intralogistics, which confront system integrators and technology users with completely new challenges. Rapidly growing online trade and other factors such as urbanization, globalization, individualization and the ever-increasing performance expectations of end customers require new automation technologies with scaled-down, more flexible and uncomplicated solutions to address these challenges.

What exactly are these challenges?

Till: Millions of small, individually prepared packages, for example, have to be sorted every day and sent to countless different destinations. Recipients in metropolitan areas expect lightning-fast deliveries, which requires local logistics centers. At the same time, however, space for

these is becoming increasingly limited - and more expensive, especially in urban areas. Furthermore, in today's VUCA world, business processes are changing faster and faster, which means that the underlying processes in distribution centers and warehouse facilities need to be adapted more and more frequently. With Flowsort's modular sorting modules, we meet the demand for maximum flexibility and overcome many other challenges.

Flow

Definition: a Noun, but also a Verb (to flow)

Significance (psychology):

Flow describes the mental state feeling in which a person performing some activity is fully immersed with energized focus, full involvement, and enjoyment in the process of the activity.

Why did FATH choose Flowsort?

Till:

The exciting thing about Flowsort is

that we take an "open interface" approach. This means that the connection of the Flowsort modules works plug&play with all other surrounding technologies. The approach is radically different from that taken by competitors. They often try to bring more integrated systems to the market. As in the field of aluminium profile components, **FATH**

also pursues the idea with Flowsort that integrators and users should be as free as possible to decide which systems and technologies they want to combine to create their optimum solution.



What are the specific benefits of Flowsort?

Till: The portfolio consists of three different types of standard modules: Single Line Diverter, Double Line Diverter and ZigZag Diverter. The smart modular concept enables system integrators to offer their customers ideal sorting solutions for a wide range of applications. In a nutshell: Flowsort is quick and easy to install. The system integrator is delighted. Flowsort is flexible and highly scalable, it offers a wide range of features and only requires a small initial investment. That's good news for the technology user.

What about the software?

Till: Simplicity doesn't just apply to the hardware – it also applies to the software. The Flowsort modules are equipped with control cards commonly used in intralogistics automation. They can be directly

connected to the control system's PLC. Plug & Play. It couldn't be any easier. Planning and installation work is minimal. Even a retrofit of systems that have not previously been **automated is possible with** the modules - simply remove a few rolls from the conveyor and insert the sorting modules. That's lean!

What do end users appreciate most about Flowsort?

Till: Modularity and flexibility! Systems with Flowsort modules can be reconfigured and adapted with little effort. Users can begin with just a few modules and then expand their system quickly and easily when needs change. The "Flow" also offers a decisive advantage: The blue rollers gently deflect the material to be sorted without abrupt braking or the risk of mechanical collision. This is important for fragile products.

What synergies result from the interaction of Flowsort with other FATH solutions?

Till: The need for flexible design and rapid adaptation of automated intralogistics processes is leading to the increasing use of aluminum profile systems in this sector. In addition, modern intralogistics facilities are designed for maximum efficiency and minimum waste. Here's where our LEAN 4.0 solutions, such as process visualization, come into play. Flowsort is the perfect bridge for **FATH** into intralogistics. Perfectly matched, we offer the customer innovative automation technology using system components and LEAN from a single source. This corresponds to the **FATH** Mission: integrated solutions that are so flexible that they fit seamlessly into almost any industrial system environment.

Flowsort therefore fits perfectly into the FATH Ecosystem.

ENGINEERING COMPONENTS

Components Work Station

Tool Hanger 8	10
Holding Bracket ST / XST 40	11
Connector for Roller Track ST / XST	12
Roller Track I 60x24	13
Holding Bracket I 60x24 40	14
Docking Clip I 60x24	15

TOOL HANGER 8

MODEL	Plastic PA, slot 8
DESCRIPTION	The tool hanger is designed to arrange tools in workshops
MATERIAL	Plastic PA
COLOR	Black
PACK QUANTITY	100 pieces
SPECIALS	Other colors on request

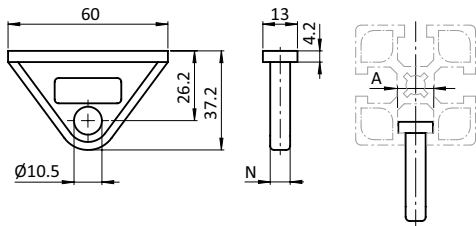

N	Weight [g]	Dimensions [mm]	Part #
8	9.9	A = 13.6	093003S01

HOLDING BRACKET ST / XST 40

MODEL	For roller tracks ST / XST
DESCRIPTION	To mount roller tracks ST / XST and guiding rails ST central to profiles 40 mm, preventing inserts from slipping out
MATERIAL	Steel
SURFACE	Zinc plated
PACK QUANTITY	10 pieces



Fig.	Version	Weight [g]	Part #
①	Without end stop	176.0	062XHD40M
②	With end stop	152.0	062XHS40M

CONNECTOR FOR ROLLER TRACK ST / XST

MODEL	For ST / XST roller tracks
DESCRIPTION	To face-to-face connect two roller tracks ST or XST for extension
MATERIAL	Steel
SURFACE	Zinc plated
SET	1 connector for roller track ST / XST, 4 self-tapping screws DIN 7500 form C - S5 x 8 - Torx T25
PACK QUANTITY	10 pieces
SPECIALS	Other surfaces, other colors on request

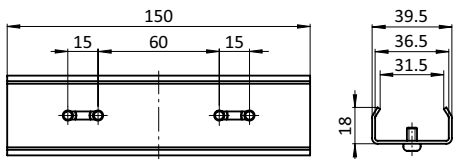

Weight [g]

Part #

156.0

062MG36MS01

ROLLER TRACK I 60X24

MODEL	Assembled ready for use
DESCRIPTION	Resilent and smooth running roller track I 60x24
MATERIAL	Roller track profile I: Steel ESD electrostatically discharging roller: Plastic PA, carbon fiber reinforced Axle: Steel
COLOR	Black
PACK QUANTITY	54 pieces (1 pallet)
SPECIALS	Other colors on request

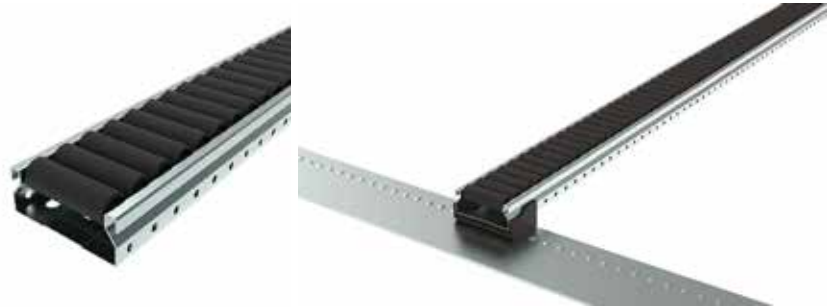
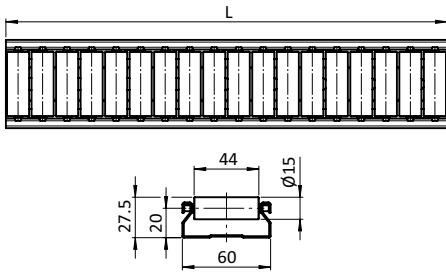

ESD	Color	Weight [g]	Part #
ESD	Black	1520.0	6IPR1591ESD.4000S01

HOLDING BRACKET I 60X24 40

MODEL	For roller tracks I 60x24
DESCRIPTION	To mount roller tracks I 60x24 40 to profiles 40 mm
MATERIAL	Steel
SURFACE	Zinc plated
PACK QUANTITY	10 pieces
SPECIALS	Other surfaces, other colors on request



Fig.	Version	Weight [g]	Part #
①	Without end stop	161.3	062IHD40M
②	With end stop	192.5	062IHSD40M

DOCKING CLIP I 60X24

MODEL	For roller tracks I 60x24
DESCRIPTION	For quick plug-in of roller tracks I 60x24 in the lateral connectors of flow beds of live storage shelvings, channel width can be adjusted horizontally in steps
MATERIAL	Plastic PA
COLOR	Gray
PACK QUANTITY	20 pieces
SPECIALS	Other colors on request

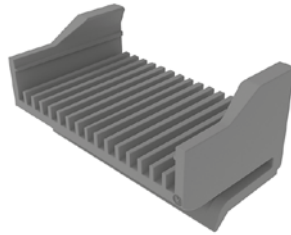
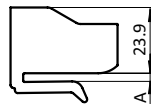
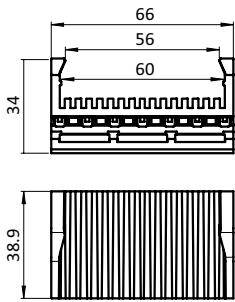

A [mm]	Color	Weight [g]	Part #
3.0 (max. 4.0)	Gray ≈ RAL 7042	29.0	062IA3572

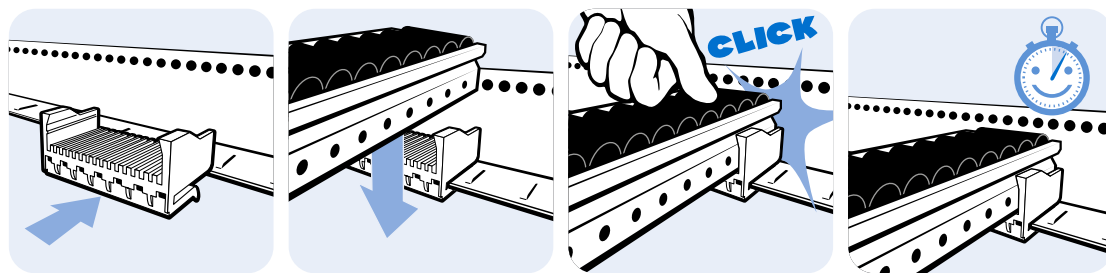

Visual Management

Floor Marking Tape 50	18
Floor Marking Tape 75	19
Floor Marking Tape 100	20
Floor Marking T-shape 50	21
Floor Marking T-shape 75	22
Floor Marking L-shape 50	23
Floor Marking L-shape 75	24
Floor Marking I-shape 50	25
Floor Marking I-shape 75	26
Floor Marking I-shape 100	27
Floor Marking Foot Shape 90	28
Floor Window DIN A5 - 5.8" x 8.3"	29
Floor Window 1/3 DIN A4 Portrait - 8.3" x 3.9"	30
Floor Window DIN A4 - 8.3" x 11.7"	31
Floor Window 1/2 DIN A4 Landscape - 11.7" x 4.1"	32
Message Frame DIN A4 - 8.3" x 11.7" (Set)	33
Message Frame DIN A3 - 11.7" x 16.5" (Set)	34
Closing Clip	35
Hanging Hook	36
Swivel Loop	37
S-hook	38
Tube Clamp	39
Swivel Magnet Holder	40
Aluminum Tube (Set)	41
Knotted Chain	42
Ceiling Magnet with Hook	43
Sign Holder AL (Set)	44
Sign Holder AL (Set)	45
Inserting Systems	
Product portrait Inserting Systems	46
Inserting Box DIN A5 Landscape - 8.3" x 5.8"	48
Inserting Box 1/3 DIN A4 Portrait - 8.3" x 3.9"	49
Inserting Box DIN A4 Portrait - 8.3" x 11.7"	50
Window for Inserting Boxes	51
KANBAN Wall Bracket for Inserting Boxes	52
Wall File Pocket	53
Magnet for Inserting Systems (Set)	54
Board Marker with Felt Eraser (Set)	55
Cleaning Spray for Board Marker	56
Refill Felt Pad for Eraser, Self-adhesive	57

FLOOR MARKING TAPE 50

MODEL	Diverse colors
DESCRIPTION	For easy and reliable marking of path boundaries, stairs, parking / storage / working areas etc., self-adhesive; Forklift-resistant and stable floor marking with outstanding adhesive strength, suitable for almost all industrial floors, removable without leaving residue
MATERIAL	Plastic PVC
COLOR	Yellow, red, blue, green, white, black / yellow, red / white
FASTENING	Self-adhesive surface on the backside
PACK QUANTITY	50 meters (spool)

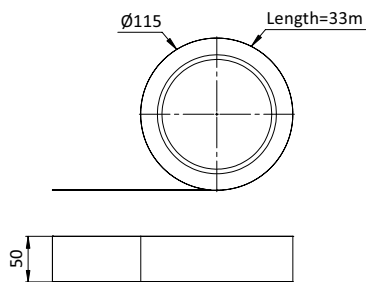
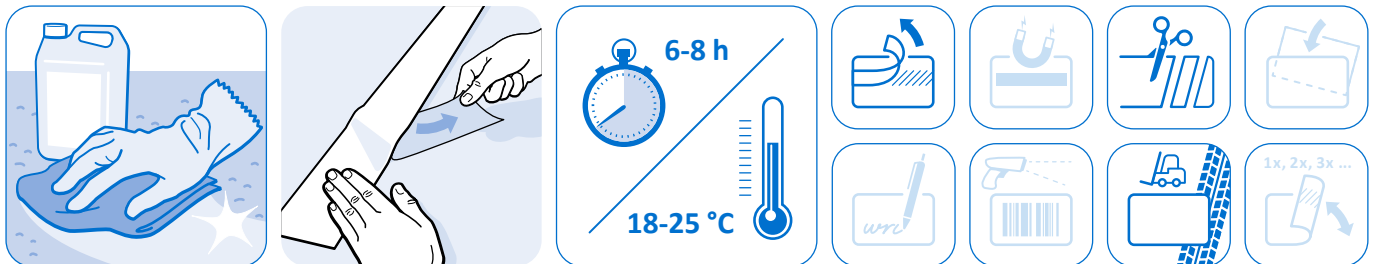

Fig.	Color	Weight [g]	Part #
③	Blue ≈ RAL 5012	1664.0	0203T05056
⑥	White ≈ RAL 9003	1664.0	0203T05093



FLOOR MARKING TAPE 75

MODEL	Diverse colors
DESCRIPTION	For easy and reliable marking of path boundaries, stairs, parking / storage / working areas etc., self-adhesive; Forklift-resistant and stable floor marking with outstanding adhesive strength, suitable for almost all industrial floors, removable without leaving residue
MATERIAL	Plastic PVC
COLOR	Yellow, red, blue, green, white
FASTENING	Self-adhesive surface on the backside
PACK QUANTITY	50 meters (spool)

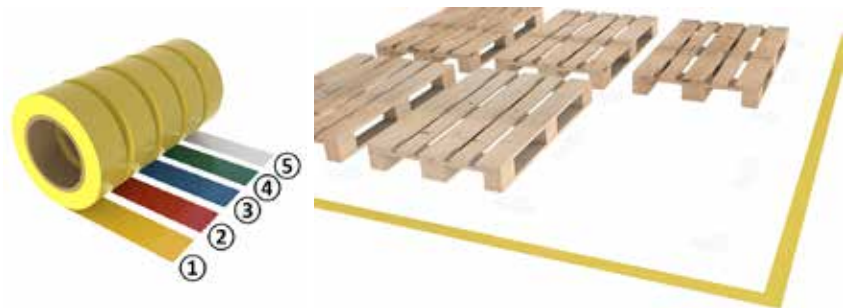
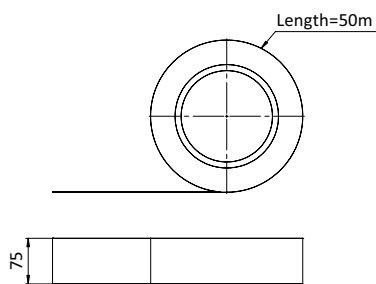
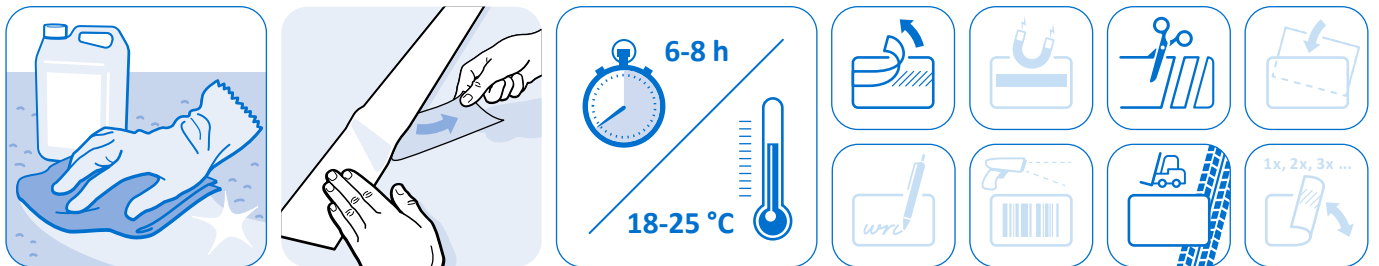

Fig.	Color	Weight [g]	Part #
⑤	White ≈ RAL 9003	2500.0	0203T07593



FLOOR MARKING TAPE 100

MODEL	Diverse colors
DESCRIPTION	For easy and reliable marking of path boundaries, stairs, parking / storage / working areas etc., self-adhesive; Forklift-resistant and stable floor marking with outstanding adhesive strength, suitable for almost all industrial floors, removable without leaving residue
MATERIAL	Plastic PVC
COLOR	Yellow, blue, white
FASTENING	Self-adhesive surface on the backside
PACK QUANTITY	50 meters (spool)

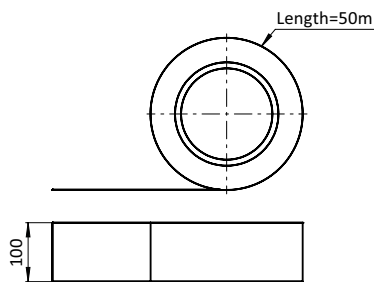
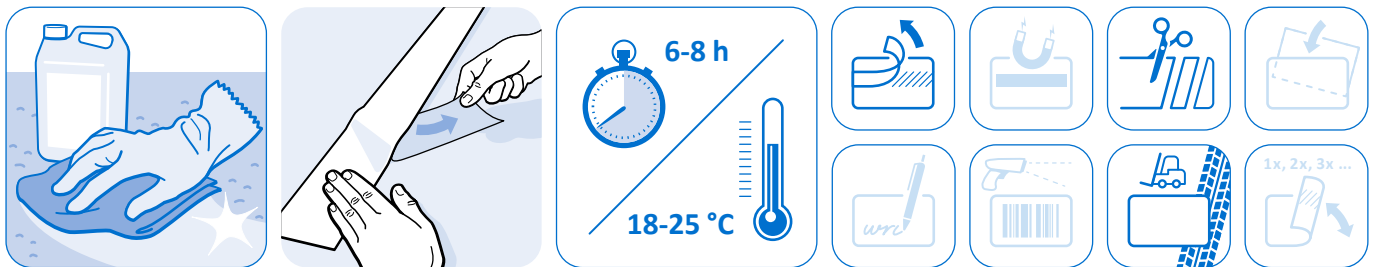

Fig.	Color	Weight [g]	Part #
②	Blue ≈ RAL 5012	3220.0	0203T10056
③	White ≈ RAL 9003	3220.0	0203T10093



FLOOR MARKING T-SHAPE 50

MODEL	Diverse colors
DESCRIPTION	For easy and reliable marking of parking / storage areas etc., self-adhesive; Forklift-resistant and stable floor marking with outstanding adhesive strength, suitable for almost all industrial floors, removable without leaving residue
MATERIAL	Plastic PVC
COLOR	Yellow, red, blue, green, white
FASTENING	Self-adhesive surface on the backside
PACK QUANTITY	40 pieces
TIP	Suitable floor marking tape 50 see 0203T05015

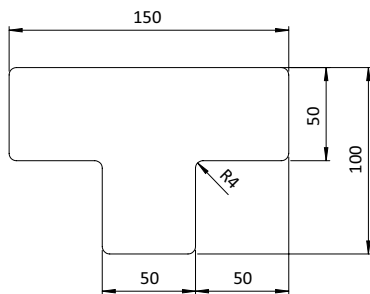

Fig.	Color	Weight [g]	Part #
⑤	White ≈ RAL 9003	7.0	0203HT05093



FLOOR MARKING T-SHAPE 75

MODEL	Diverse colors
DESCRIPTION	For easy and reliable marking of parking / storage areas etc., self-adhesive; Forklift-resistant and stable floor marking with outstanding adhesive strength, suitable for almost all industrial floors, removable without leaving residue
MATERIAL	Plastic PVC
COLOR	Yellow, red, blue, green, white
FASTENING	Self-adhesive surface on the backside
PACK QUANTITY	40 pieces
TIP	Suitable floor marking tape 75 see 0203T07515

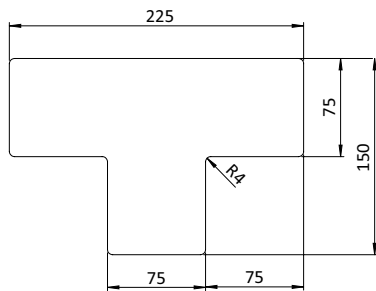

Fig.	Color	Weight [g]	Part #
⑤	White ≈ RAL 9003	15.0	0203HT07593



FLOOR MARKING L-SHAPE 50

MODEL	Diverse colors
DESCRIPTION	For easy and reliable marking of parking / storage areas etc., self-adhesive; Forklift-resistant and stable floor marking with outstanding adhesive strength, suitable for almost all industrial floors, removable without leaving residue
MATERIAL	Plastic PVC
COLOR	Yellow, red, blue, green, white
FASTENING	Self-adhesive surface on the backside
PACK QUANTITY	40 pieces
TIP	Suitable floor marking tape 50 see 0203T05015

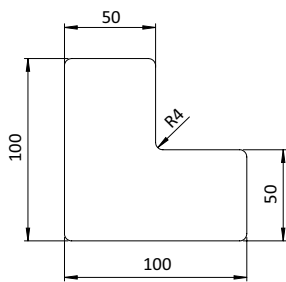

Fig.	Color	Weight [g]	Part #
⑤	White ~ RAL 9003	5.0	0203HL05093



FLOOR MARKING L-SHAPE 75

MODEL	Diverse colors
DESCRIPTION	For easy and reliable marking of parking / storage areas etc., self-adhesive; Forklift-resistant and stable floor marking with outstanding adhesive strength, suitable for almost all industrial floors, removable without leaving residue
MATERIAL	Plastic PVC
COLOR	Yellow, red, blue, green, white
FASTENING	Self-adhesive surface on the backside
PACK QUANTITY	40 pieces
TIP	Suitable floor marking tape 75 see 0203T07515

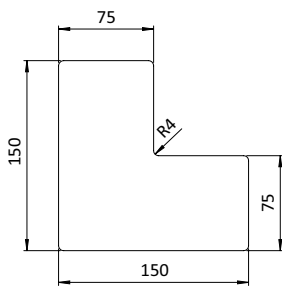

Fig.	Color	Weight [g]	Part #
⑤	White ≈ RAL 9003	12.0	0203HL07593



FLOOR MARKING I-SHAPE 50

MODEL	Diverse colors
DESCRIPTION	For easy and reliable marking of parking / storage areas etc., self-adhesive; Forklift-resistant and stable floor marking with outstanding adhesive strength, suitable for almost all industrial floors, removable without leaving residue
MATERIAL	Plastic PVC
COLOR	Yellow, red, blue, green, white
FASTENING	Self-adhesive surface on the backside
PACK QUANTITY	40 pieces
TIP	Suitable floor marking tape 50 see 0203T05015

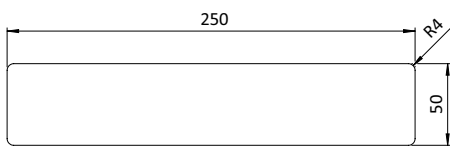

Fig.	Color	Weight [g]	Part #
⑤	White ≈ RAL 9003	9.0	0203HI05093



FLOOR MARKING I-SHAPE 75

MODEL	Diverse colors
DESCRIPTION	For easy and reliable marking of parking / storage areas etc., self-adhesive; Forklift-resistant and stable floor marking with outstanding adhesive strength, suitable for almost all industrial floors, removable without leaving residue
MATERIAL	Plastic PVC
COLOR	Yellow, red, blue, green, white
FASTENING	Self-adhesive surface on the backside
PACK QUANTITY	40 pieces
TIP	Suitable floor marking tape 75 see 0203T07515

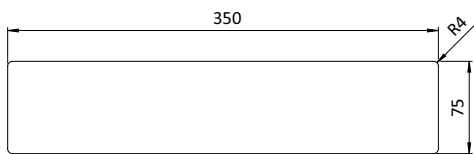
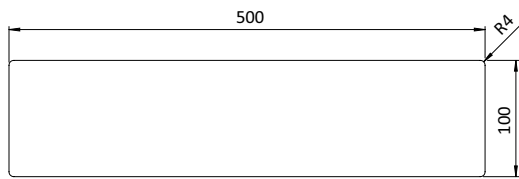

Fig.	Color	Weight [g]	Part #
⑤	White ≈ RAL 9003	18.0	0203HI07593



FLOOR MARKING I-SHAPE 100

MODEL	Diverse colors
DESCRIPTION	For easy and reliable marking of parking / storage areas etc., self-adhesive; Forklift-resistant and stable floor marking with outstanding adhesive strength, suitable for almost all industrial floors, removable without leaving residue
MATERIAL	Plastic PVC
COLOR	White
FASTENING	Self-adhesive surface on the backside
PACK QUANTITY	40 pieces
TIP	Suitable floor marking tape 100 see 0203T10093



	Color	Weight [g]	Part #
	White ≈ RAL 9003	25.0	0203HI10093



FLOOR MARKING FOOT SHAPE 90

MODEL	Diverse colors
DESCRIPTION	For easy and reliable marking of parking / storage areas etc., self-adhesive; Forklift-resistant and stable floor marking with outstanding adhesive strength, suitable for almost all industrial floors, removable without leaving residue
MATERIAL	Plastic PVC
COLOR	Yellow, red, blue, green, white
FASTENING	Self-adhesive surface on the backside
PACK QUANTITY	40 pieces

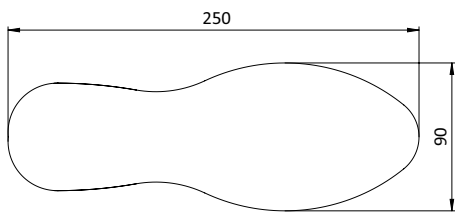

Fig.	Color	Weight [g]	Part #
⑤	White ≈ RAL 9003	11.0	0203HF09093



FLOOR WINDOW DIN A5 - 5.8" X 8.3"

MODEL	Diverse colors
DESCRIPTION	For easy and reliable marking of parking / storage areas etc., self-adhesive; Forklift-resistant and stable floor window with outstanding adhesive strength, suitable for almost all industrial floors, removable without leaving residue Scanner-compatible
MATERIAL	Plastic PVC
COLOR	Yellow, red, blue, green, white
FASTENING	Self-adhesive strip on the backside
PACK QUANTITY	10 pieces

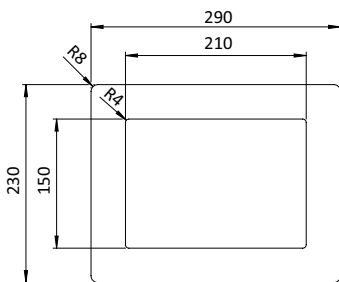

Fig.	Color	Weight [g]	Part #
⑤	White ≈ RAL 9003	45.0	0203WRA593

FLOOR WINDOW 1/3 DIN A4 PORTRAIT - 8.3" X 3.9"

MODEL	Diverse colors
DESCRIPTION	For easy and reliable marking of parking / storage areas etc., self-adhesive; Forklift-resistant and stable floor window with outstanding adhesive strength, suitable for almost all industrial floors, removable without leaving residue Scanner-compatible
MATERIAL	Plastic PVC
COLOR	Yellow, red, blue, green, white
FASTENING	Self-adhesive strip on the backside
PACK QUANTITY	10 pieces

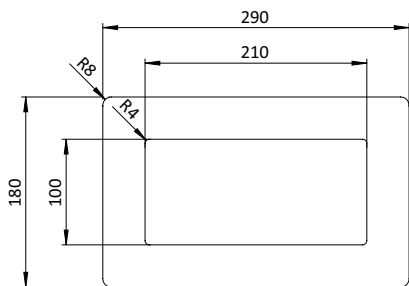

Fig.	Color	Weight [g]	Part #
⑤	White ≈ RAL 9003	40.0	0203WRA1/393

FLOOR WINDOW DIN A4 - 8.3" X 11.7"

MODEL	Diverse colors
DESCRIPTION	For easy and reliable marking of parking / storage areas etc., self-adhesive; Forklift-resistant and stable floor window with outstanding adhesive strength, suitable for almost all industrial floors, removable without leaving residue Scanner-compatible
MATERIAL	Plastic PVC
COLOR	Yellow, red, blue, green, white
FASTENING	Self-adhesive strip on the backside
PACK QUANTITY	10 pieces

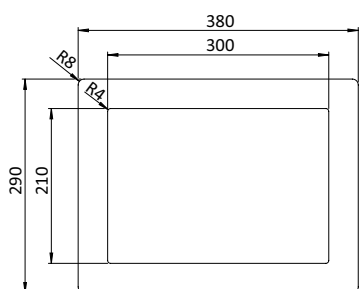

Fig.	Color	Weight [g]	Part #
⑥	White ≈ RAL 9003	70.0	0203WRA493

FLOOR WINDOW 1/2 DIN A4 LANDSCAPE - 11.7" X 4.1"

MODEL	Diverse colors
DESCRIPTION	For easy and reliable marking of parking / storage areas etc., self-adhesive; Forklift-resistant and stable floor window with outstanding adhesive strength, suitable for almost all industrial floors, removable without leaving residue Scanner-compatible
MATERIAL	Plastic PVC
COLOR	Yellow, red, blue, green, white
FASTENING	Self-adhesive strip on the backside
PACK QUANTITY	10 pieces

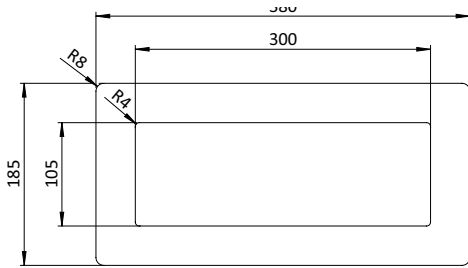

Fig.	Color	Weight [g]	Part #
①	Yellow ≈ RAL 1018	50.0	0203WRA1/215
②	Red ≈ RAL 3020	50.0	0203WRA1/231
③	Blue ≈ RAL 5017	50.0	0203WRA1/255
④	Green ≈ RAL 6016	50.0	0203WRA1/263
⑤	White ≈ RAL 9003	50.0	0203WRA1/293

MESSAGE FRAME DIN A4 - 8.3" X 11.7" (SET)

MODEL	DIN A4 - 8.3" x 11.7"
DESCRIPTION	For well visible labeling of shelves and storage spaces Usable from both sides due to transparent foil; Scanner friendly due to antireflective foil Diverse frame colors for individual visualization Applicable in portrait or landscape format
MATERIAL	Frame: Plastic PS Transparent foil: Plastic PET Clip: Plastic PC
COLOR	Yellow, blue, green, gray, black, white
SET	1 frame 1 transparent foil 1 clip
PACK QUANTITY	5 set
SPECIALS	Other colors on request
TIP	Compatible closing clip see 02042CC Compatible hanging hook see 02042HH Compatible swivel loop see 02042SE Compatible tube clamp see 02042PC Compatible swivel magnet holder see 02042MH

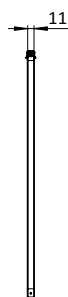
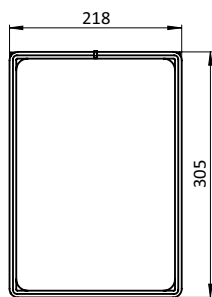

Fig.	Color	Weight [g]	Part #
①	Yellow ≈ RAL 1016	744.0	02041A415
②	Blue ≈ RAL 5015	744.0	02041A455
③	Green ≈ RAL 6029	744.0	02041A463
④	Gray ≈ RAL 7045	744.0	02041A475
⑤	Black ≈ RAL 9005	744.0	02041A491
⑥	White ≈ RAL 9001	744.0	02041A493

MESSAGE FRAME DIN A3 - 11.7" X 16.5" (SET)

MODEL	DIN A3 - 11.7" x 16.5"
DESCRIPTION	For well visible labeling of shelves and storage spaces Usable from both sides due to transparent foil; Scanner friendly due to antireflective foil Diverse frame colors for individual visualization Applicable in portrait or landscape format
MATERIAL	Frame: Plastic PS Transparent foil: Plastic PET Clip: Plastic PC
COLOR	Yellow, blue, green, gray, black, white
SET	1 frame 1 transparent foil 1 clip
PACK QUANTITY	5 set
TIP	Compatible closing clip see 02042CC Compatible hanging hook see 02042HH Compatible swivel loop see 02042SE Compatible tube clamp see 02042PC Compatible swivel magnet holder see 02042MH

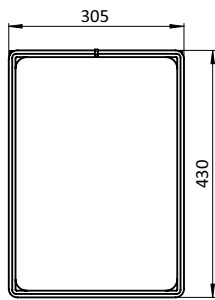
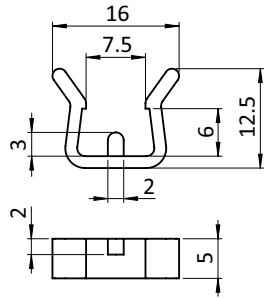

Fig.	Color	Weight [g]	Part #
①	Yellow ≈ RAL 1016	1350.0	02041A315
②	Blue ≈ RAL 5015	1350.0	02041A355
③	Green ≈ RAL 6029	1350.0	02041A363
④	Gray ≈ RAL 7045	1350.0	02041A375
⑤	Black ≈ RAL 9005	1350.0	02041A391
⑥	White ≈ RAL 9001	1350.0	02041A393

CLOSING CLIP

MODEL	For message frames DIN A4 - 8.3" x 11.7" and DIN A3 - 11.7" x 16.5"
DESCRIPTION	For closing message frames, prevents transparent foil from falling out
MATERIAL	Plastic PC
COLOR	Transparent
PACK QUANTITY	10 pieces
SPECIALS	Other colors on request
TIP	Compatible message frame DIN A4 - 8.3" x 11.7" see 02041A415 Compatible message frame DIN A3 - 11.7" x 16.5" see 02041A315



Weight [g]	Part #
0.3	02042CC

HANGING HOOK

MODEL	For message frames DIN A4 - 8.3" x 11.7" and DIN A3 - 11.7" x 16.5"
DESCRIPTION	Fast and easy hanging of message frames, Easy swap of message frames due to open hooks
MATERIAL	Plastic PC
COLOR	Transparent
PACK QUANTITY	10 pieces
TIP	Compatible swivel loop see 02042SE Compatible S-hook see 02042SH Compatible knotted chain see 02042KC Compatible message frame DIN A4 - 8.3" x 11.7" see 02041A415 Compatible message frame DIN A3 - 11.7" x 16.5" see 02041A315

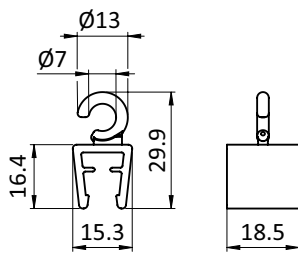

Weight [g]	Part #
2.3	02042HH

SWIVEL LOOP

MODEL	For message frames DIN A4 - 8.3" x 11.7" and DIN A3 - 11.7" x 16.5"
DESCRIPTION	Fast and easy hanging of message frames, Secure hanging due to closed loop 360° rotatable
MATERIAL	Plastic PA
COLOR	Transparent
PACK QUANTITY	10 pieces
TIP	Compatible hanging hook see 02042HH Compatible S-hook see 02042SH Compatible knotted chain see 02042KC Compatible message frame DIN A4 - 8.3" x 11.7" see 02041A415 Compatible message frame DIN A3 - 11.7" x 16.5" see 02041A315

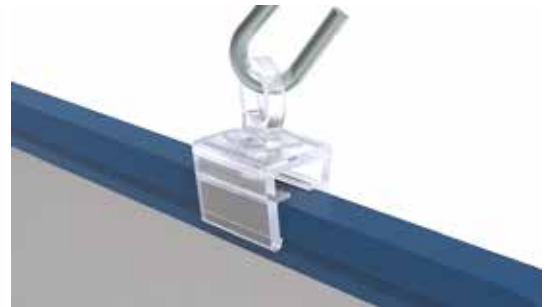
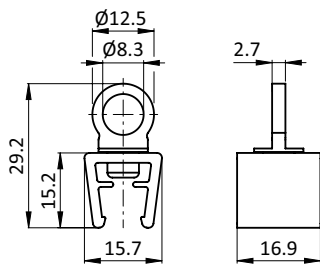

	Weight [g]	Part #
	2.2	02042SE

S-HOOK

MODEL	For message frames DIN A4 - 8.3" x 11.7" and DIN A3 - 11.7" x 16.5"
DESCRIPTION	Fast and easy hanging of message frames
MATERIAL	Steel
SURFACE	Zinc plated
PACK QUANTITY	10 pieces
TIP	Compatible knotted chain see 02042KC Compatible message frame DIN A4 - 8.3" x 11.7" see 02041A415 Compatible message frame DIN A3 - 11.7" x 16.5" see 02041A315

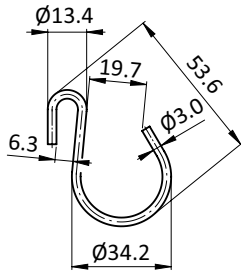

Weight [g]	Part #
6.4	02042SH

TUBE CLAMP

MODEL	For message frames DIN A4 - 8.3" x 11.7" and DIN A3 - 11.7" x 16.5"
DESCRIPTION	Durable mounting of message frames, Easy to attach to tubes and tubular frame profiles with Ø 28 mm - 30 mm outer diameter
MATERIAL	Plastic PA
COLOR	Transparent
PACK QUANTITY	10 pieces
TIP	Compatible aluminum tube (set) see 02042AT Compatible message frame DIN A4 - 8.3" x 11.7" see 02041A415 Compatible message frame DIN A3 - 11.7" x 16.5" see 02041A315

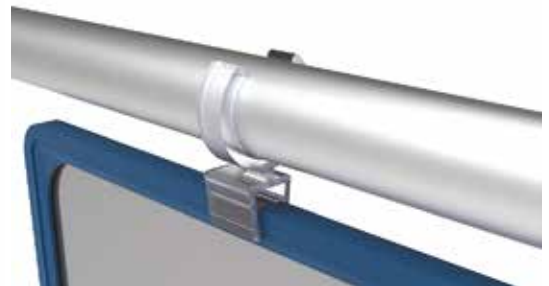
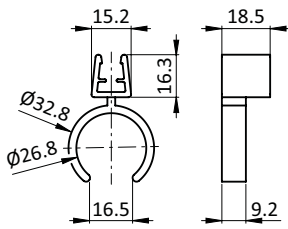

Weight [g]	Profile	Part #
4.6	Ø 28 mm - 30 mm	02042PC

SWIVEL MAGNET HOLDER

MODEL	For message frames DIN A4 - 8.3" x 11.7" and DIN A3 - 11.7" x 16.5"
DESCRIPTION	For hanging message frames Fast and easy mounting with integrated magnet 360° rotatable
MATERIAL	Plastic PA
COLOR	Transparent
PACK QUANTITY	10 pieces
TIP	Compatible message frame DIN A4 - 8.3" x 11.7" see 02041A415 Compatible message frame DIN A3 - 11.7" x 16.5" see 02041A315

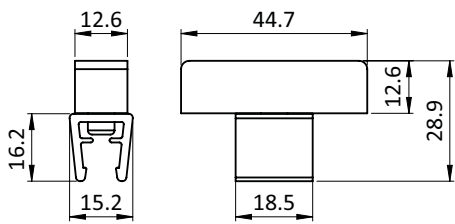

Weight [g]	Part #
20.6	02042MH

ALUMINUM TUBE (SET)

MODEL	For message frames DIN A4 - 8.3" x 11.7" and DIN A3 - 11.7" x 16.5"
DESCRIPTION	To hang up message frames with pipe clamps, several message frames can be attached next to another. Helpful visualization even in greater heights.
MATERIAL	Tube: Aluminum Cover caps: Plastic TPE
SURFACE	Tube: Anodized
COLOR	Cover caps: Gray ≈ RAL 7042
SET	1 aluminum tube 2 cover caps
PACK QUANTITY	1 set
TIP	Compatible tube clamp see 02042PC Compatible knotted chain 02042KC

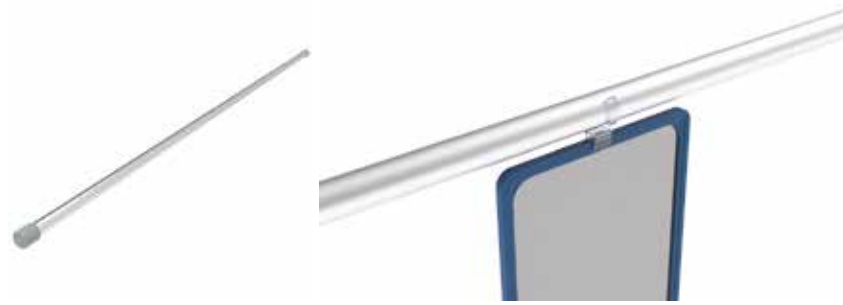
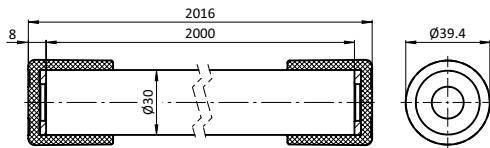

	Weight [g]	Part #
	495.0	02042AT

KNOTTED CHAIN

MODEL	For message frames DIN A4 - 8.3" x 11.7" and DIN A3 - 11.7" x 16.5"
DESCRIPTION	Durable and easy hanging of message frames; Easy shortening of the chain
MATERIAL	Steel
SURFACE	Zinc plated
PACK QUANTITY	30 meters (1 spool)
TIP	Compatible ceiling magnet with hook see 02042CM Compatible S-hook see 02042SH Compatible message frame DIN A4 - 8.3" x 11.7" see 02041A415 Compatible message frame DIN A3 - 11.7" x 16.5" see 02041A315

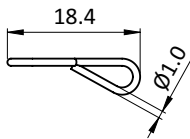

Weight [g]
776.0

Part #
02042KC

CEILING MAGNET WITH HOOK

MODEL	For message frames DIN A4 - 8.3" x 11.7" and DIN A3 - 11.7" x 16.5"
DESCRIPTION	For hanging message frames Fast and easy mounting with integrated magnet
MATERIAL	Casing: Plastic PA Magnet: Neodymium
COLOR	White
MAX. LOAD	10 kg
PACK QUANTITY	1 piece
TIP	Compatible knotted chain see 02042KC

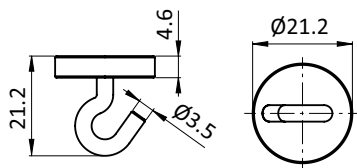

Weight [g]	Part #
13.3	02042CM

SIGN HOLDER AL (SET)

MODEL	Aluminum
DESCRIPTION	Durable mounting of signs
MATERIAL	Sign holder: Aluminum Sign foil: Plastic PET Cover Caps: Plastic PA, glass ball reinforced Screws: Steel
SURFACE	Sign holder: Anodized Screws: Zinc plated
COLOR	Cover Caps: Gray
SET	1 Sign Holder 1 Sign foil 2 Cover Caps 8 Screws 3.9 x 16
PACK QUANTITY	1 set
TIP	Compatible direct connector I, slot 8 see 099DC084040N08 Compatible T-connector plate see 093VAD28V Compatible friction joints I40H see 061FGZ40LN08 Compatible friction joints I80H see 061FGZ80HN08



	Version	L [mm]	Slot	Size	Weight [g]	Profile	Part #
	Sign Holder AL DIN A4 - 8.3" x 11.7"	220	8	DIN A4	914.55	I	02064A4N0874
	Sign Holder AL DIN A3 - 11.7" x 16.5"	430	8	DIN A3	1786.81	I	02064A3N0874
	Sign Holder AL 297 x 1000 - 11.7" x 39.4"	990	8	Oversize	4114.48	I	02064OSN0874



SIGN HOLDER AL (SET)

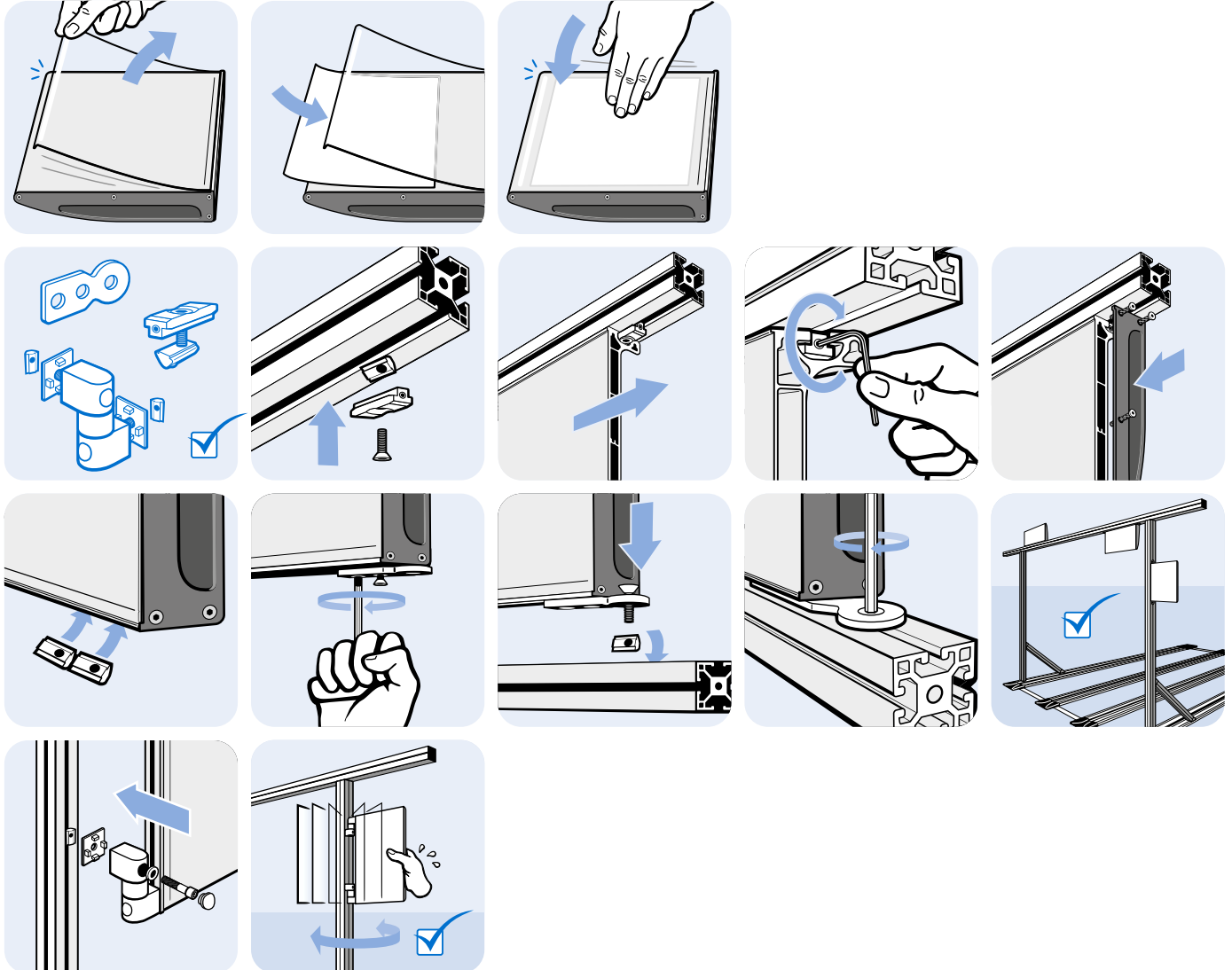



FATH®

INSERTING SYSTEMS

Efficiently structure production processes and the flow of goods and information with FATH Inserting Systems



- Document holders for sizes DIN A4, DIN A5 and 1/3 DIN A4
- Wall mounting, e.g., for Kanban boards
- Break-proof document holder for single use, e.g., as a mailbox
- Simple and clear provision of information throughout the entire shopfloor

HIGHLIGHTS

FATH Inserting Systems for document sizes DIN A4, DIN A5 and 1/3 DIN A4 are a simple tool for implementing the Kanban principle in line with lean production. This creates an efficient organizational structure that ensures oversight in daily production operations.

The inserting system boxes ensure a seamless process in the provision of information and materials. The desired sequence for order processing can be controlled by using the inserted cards.

Single compartment, Kanban box or Kanban board: In day-to-day operations, the inserting system boxes provide quick access to the relevant information and allow processes to be put in the right order.

Practical wall mounting for clear structure and quick oversight: Sturdy metal wall brackets for screwing onto profiles, walls or machines are available as accessories for all **FATH** inserting system boxes. This means you can implement your individual inserting system and quickly and easily adapt it to changing requirements at any time.

**MORE EFFICIENT
FLOW OF GOODS &
INFORMATION**



Inserting system boxes for walls and Kanban boards

Boxes for A4 documents hold construction drawings, shipping documents, etc. If the A4 documents are folded, A5 inserting system boxes can be used and the space requirement will be significantly smaller. When placed one below the other, the individual inserting system boxes create a column that can be used as a Kanban board.

The boxes show which activity is to be processed next or what should be produced in the next step. A system as simple as it is efficient.

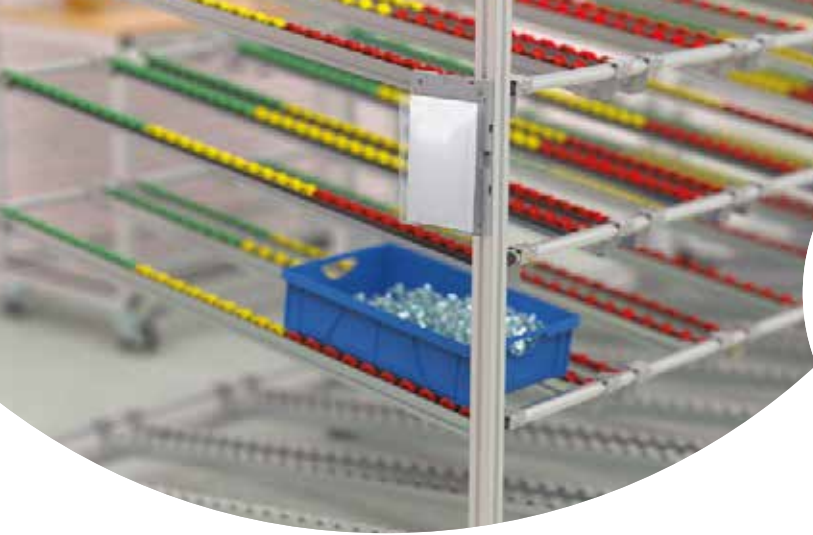

FATH®

Kanban board: FATH inserting system for Kanban cards

The 1/3 DIN A4 boxes are specially designed for Kanban cards in accordance with the VDA standard. When the material is used up, the Kanban card is removed from the Kanban container and inserted into the corresponding box on the Kanban board. This signals the need for replenishment and the production can be continued without lead times being affected. That's lean!

FATH Document Holders: comprehensive information under control

FATH screw-on document holders made of break-proof plastic can serve as a single compartment for a stack of documents or for files of all kinds, such as orders with multi-page drawings and test reports, or as a collection box for Kanban cards. There is also room in the holders for thicker document stacks and process folders. In the logistics and production process, they provide a quick overview and full transparency in another respect: **FATH** Document Holders are themselves transparent.

FATH Document Holders have two parts. The solid plastic mounting plate is screwed to the wall, the machine or the profile. The transparent front part can easily be snapped into place on this sturdy bracket. The front of the inserting system box is cut out for quick access to smaller documents. The document holders are made of extremely shatterproof special plastic and can be used in any production environment.

Accessories:

FATH inserting systems can be adapted even better to your needs with the following accessories:

- Kanban wall holder
- magnets (set)

Versions:



FATH Inserting Systems are available in the following versions:

Systems / document size
Inserting system boxes for column formation

- DIN A4 portrait
- DIN A5 landscape
- 1/3 DIN A4 portrait / VDA standard

with additional viewing windows in

- 1/3 DIN A4 landscape, small & portrait, large
- DIN A4 landscape, small & portrait, large
- DIN A5 landscape, small & portrait, large



Document holder as a single compartment

- DIN A5 portrait & landscape
- DIN A4 portrait & landscape

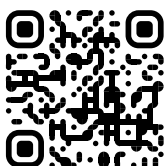

Would you like to learn
more about **FATH**
Inserting Systems?

inserting-system.fath24.com

INSERTING BOX DIN A5 LANDSCAPE - 8.3" X 5.8"

MODEL	For wall attachment
DESCRIPTION	For holding KANBAN cards, column formation through special design possible, modular construction
MATERIAL	Plastic ABS
COLOR	Gray
PACK QUANTITY	10 pieces
TIP	Compatible magnet see 02021N45G, Compatible window see 02052E03A4P Compatible labels on request

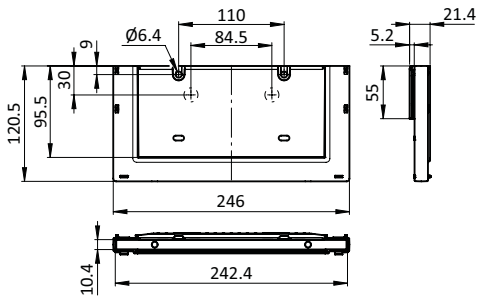

Weight [g]

Part #

108.0

02052A5L75

INSERTING BOX 1/3 DIN A4 PORTRAIT - 8.3" X 3.9"

MODEL	For wall attachment
DESCRIPTION	For holding KANBAN cards, column formation through special design possible, modular construction
MATERIAL	Plastic ABS
COLOR	Gray
PACK QUANTITY	50 pieces
TIP	Compatible magnet see 02021N45G, Compatible window see 02052E03A4P Compatible labels on request

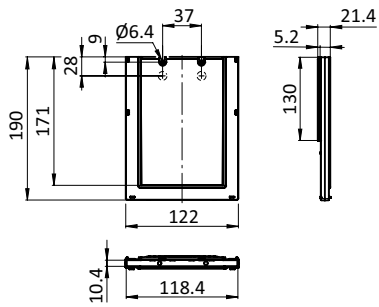

Weight [g]	Part #
99.0	02052A1/375

INSERTING BOX DIN A4 PORTRAIT - 8.3" X 11.7"

MODEL	For wall attachment
DESCRIPTION	For holding KANBAN cards, column formation through special design possible, modular construction
MATERIAL	Plastic ABS
COLOR	Gray
PACK QUANTITY	10 pieces
TIP	Compatible magnet see 02021N45G, Compatible window see 02052E03A4P Compatible labels on request

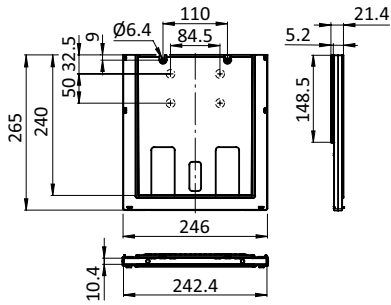

Weight [g]

Part #

221.0

02052A4P75

WINDOW FOR INSERTING BOXES

MODEL	For inserting boxes
DESCRIPTION	See through insert to protect cardboard inlays of inserting boxes
MATERIAL	Plastic PET
PACK QUANTITY	10 pieces

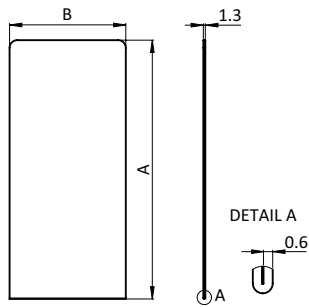

	Version	Weight [g]	Part #
	1/3 DIN A4 - 8.3" x 3.9" - Landscape, small	5.0	02052E03A1-301
	1/3 DIN A4 - 8.3" x 3.9" - Portrait, large	22.0	02052E04A1-301
	DIN A4 - 8.3" x 11.7" - Landscape, small	31.0	02052E03A4P
	DIN A4 - 8.3" x 11.7" - Portrait, large	83.0	02052E04A4P
	DIN A5 - 8.3" x 5.8" - Landscape, small	14.0	02052E03A5L
	DIN A5 - 8.3" x 5.8" - Portrait, large	34.0	02052E04A5L

KANBAN WALL BRACKET FOR INSERTING BOXES

MODEL	For inserting boxes
DESCRIPTION	Screw-on wall bracket for mounting inserting boxes on walls or whiteboards
MATERIAL	Steel
PACK QUANTITY	1 piece
TIP	Compatible magnet (set) for KANBAN wall bracket DIN A5 / A4 see 02021N35G Compatible magnet (set) for KANBAN wall bracket 1/3 DIN A4 see 02021N75G Compatible magnet (set) for KANBAN Wall Bracket Support Angle see 02021N45G



	Version	Weight [g]	Part #
	KANBAN Wall Bracket for Inserting Box DIN A5 / A4	275.0	02052E02A4A5PR01
	KANBAN Wall Bracket for Inserting Box 1/3 DIN A4	205.0	02052E02A1-3R01
	KANBAN Wall Bracket Support Angle for Inserting Boxes	26.5	02052E02AR02

WALL FILE POCKET

MODEL	For wall attachment
DESCRIPTION	For organizing documents on the shopfloor High capacity, shatter-proof, dirt-resistant
MATERIAL	Mounting Plate: Plastic ABS Wall File Pocket Component Clear: Plastic PC
COLOR	Mounting Plate: Gray Wall File Pocket Component Clear: Transparent
SET 1	1 Mounting Plate A5 Portrait 8.3" x 5.8" 1 Wall File Pocket Component Clear A5 Portrait 8.3" x 5.8"
SET 2	1 Mounting Plate A5 Landscape 8.3" x 5.8" 1 Wall File Pocket Component Clear A5 Landscape 8.3" x 5.8"
SET 3	1 Mounting Plate A4 Portrait 8.3" x 11.7" 1 Wall File Pocket Component Clear A4 Portrait 8.3" x 11.7"
SET 4	1 Mounting Plate A4 Landscape 8.3" x 11.7" 1 Wall File Pocket Component Clear A4 Landscape 8.3" x 11.7"
PACK QUANTITY	1 set
TIP	Compatible magnet see 02021N45G

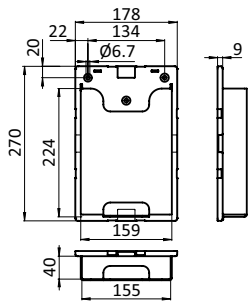

Fig.	Set	Version	Weight [g]	Part #
①	Set 1	DIN A5 - 8.3" x 5.8" - Portrait	270.0	02051A5PS01
②	Set 2	DIN A5 - 8.3" x 5.8" - Landscape	260.0	02051A5LS01
③	Set 3	DIN A4 - 8.3" x 11.7" - Portrait	500.0	02051A4PS01
④	Set 4	DIN A4 - 8.3" x 11.7" - Landscape	500.0	02051A4LS01

MAGNET FOR INSERTING SYSTEMS (SET)

MODEL	Pre-assembled
DESCRIPTION	To attach inserting boxes or wall file pockets to magnetic surfaces
MATERIAL	Magnets: Neodymium
SET 1	2 magnets Ø 15 mm 2 plastic direct screws 2 x 4
SET 2	2 magnets Ø 22 mm 2 screws M2.5
SET 3	2 magnet Ø 42 mm 2 screws M4
PACK QUANTITY	1 set

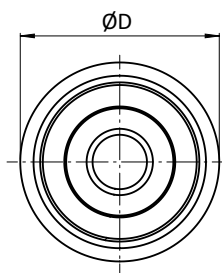
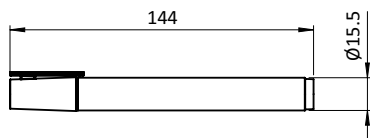

Fig.	Set	Version	ØD [mm]	Weight [g]	Part #
①	Set 1	Inserting Boxes / Wall File Pocket / Organizer UTENSILO	15	1.600	02021N45G
②	Set 2	KANBAN Wall Bracket Support Angle for Inserting Boxes	22	2.600	02021N35G
③	Set 3	KANBAN Wall Bracket for Inserting Boxes	42	4.500	02021N75G

BOARD MARKER WITH FELT ERASER (SET)

MODEL	Diverse colors
DESCRIPTION	Board marker for whiteboards and visual boards With round tip, line width 3-4 mm, dry wipeable, font color detectable at cap color In practical folded box Enclosed eraser felts Matching with organizer UTENSILO
MATERIAL	Marker: Plastic Folded box: Cardboard Eraser felt: Felt
COLOR	Marker: White Cap: Writing color Eraser felt: Natural white Writing color: See table
DIMENSIONS	Marker: 138 x 15 mm Folded box: 143 x 80 x 16 mm
SET	4 board markers, sorted by color 4 felt erasers
PACK QUANTITY	1 set
TIP	Reorderable via adhered QR code



Font Color	Weight [g]	Part #
Black	15.8	0206BM91
Red	15.8	0206BM31
Blue	15.8	0206BM55
Green	15.8	0206BM63

CLEANING SPRAY FOR BOARD MARKER

MODEL	200 ml
DESCRIPTION	For efficient cleaning of white boards and visual boards high cleaning performance, with pump sprayer Matching with organizer UTENSILO
MATERIAL	Plastic HDPE
COLOR	White ≈ RAL 9001
PACK QUANTITY	4 pieces
TIP	Reorderable via adhered QR code

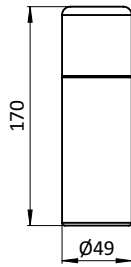

H [mm]	ØD [mm]	Weight [g]	Part #
170.0	49.0	235.0	0206U200CS

REFILL FELT PAD FOR ERASER, SELF-ADHESIVE

MODEL	Matching with wiper of organizer UTENSILO
DESCRIPTION	Easy exchange due to adhesive back, high durability, highly absorbent
MATERIAL	Felt
COLOR	Black
PACK QUANTITY	20 pieces
TIP	Reorderable via adhered QR code on board marker and cleaning spray

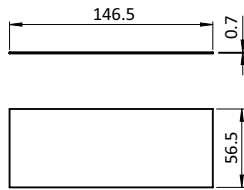

	Weight [g]	Part #
	79.5	0206FP91

WAREHOUSE AND INTRALOGISTIC AUTOMATION

Flowsort sorting systems

Product portrait flowsort Sorting modules	60
Flowsort® Single Line Diverter SLD	63
Flowsort® Single Line Diverter SLD	64
Flowsort® Double Line Diverter DLD	65
Flowsort® Double Line Diverter DLD	66
Flowsort® ZicZac Diverter ZZ	67
Electric Motor for Flowsort® Diverters	68
Control Unit ConveyLinx-Ai2 for Flowsort® Diverters	69
Control Unit MotionLinx-Ai for Flowsort® Diverters	70
Inductive Position Sensor for Flowsort® Diverters	71
Wheel Drive Assembly for Flowsort® Diverters	72
Pulley Drive Assembly for Flowsort® Diverters	73
Bevel Gear for Flowsort® Diverters	74
Timing Belt Tensioner Element for Flowsort® Diverters	75
Timing Belt Tensioner Element Revers for Flowsort® Diverters	76
Control Belt for Flowsort® Diverters	77
Transmission Belt Direction Control for Flowsort® Diverters	78
Drive Belt for Flowsort® Diverters	79
Transmission Belt Wheel Drive for Flowsort® Diverters	80



FATH®



FLOWSORT SORTING SYSTEMS

Intralogistics reinvented – modular, simple, scalable



- Sorting performance: 2,500–6,000 products per hour
- Plug & Play Easy integration in conveyor systems saves planning and installation time
- Gentle transport: Redirection of products in "Flow" - no abrupt braking or excessive mechanical force
- Scalability Sorting systems can be easily expanded at any time
- Modularity: innovative standard modules for maximum flexibility

HIGHLIGHTS

The Flowsort product portfolio consists of standardized sorting modules. With just three different modules - Single Line Diverter, Double Line Diverter and ZigZag Diverter - many different use cases can be addressed - with a single underlying system. All Flowsort sorting modules harmonize with all other intralogistics systems and technologies. They are easy to install, both in terms of hardware as well as for the software connection.

The conceptual design ensures a high degree of scalability and offers a completely new level of flexibility: Sorting performance and layout can be adjusted to meet current requirements at any time. Even retrofitting existing intralogistics systems can be easily implemented with Flowsort. And all this comes in a fresh and modern design! The "Flow" ensures that

the sorted material is diverted particularly gently, without abrupt braking or mechanical force. This makes Flowsort sorting systems suitable even for fragile goods.

The energy consumption of the modules is very low due to the operation with 24 V motors. This enables energy savings and benefits the environment. Designed and manufactured in The Netherlands, Flowsort sorting modules are very robust and ensure reliable operation of the automatic sorting system.

FLEXIBLE &
SYSTEM-
INDEPENDENT



The solution to current intralogistics challenges

In the distribution sector, smaller decentralized distribution centers are increasingly needed to ensure fast deliveries in conurbations. New automation technologies are needed to meet this challenge. Flowsort sorting modules are straightforward, flexible, quick to install, system independent and highly scalable. This makes the Flowsort modules perfect for streamlining intralogistics processes and setting up smaller distribution centers.



FATH®



flowsort
MODULAR SORTING SYSTEMS



SLD = Single Line Diverter
DLD = Double Line Diverter

The SLD (single row) and DLD (double row) are high-speed sorters that can be incorporated into any conveyor system. Flow is a modular system that you can configure according to your needs. For example, when you need a 3-row system, you connect an SLD (1-row) and a DLD (2-row) together - all plug & play. The SLD and DLD can each be ordered to the millimetre in the widths described below. This means that they can be easily and precisely installed in almost all conveyor systems.

The following widths are available:

- 400 – 450 mm
- 600 – 650 mm
- 800 – 850 mm
- 1000 -1050 mm

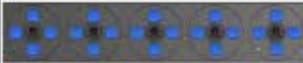
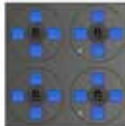
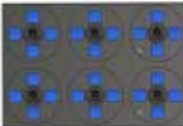
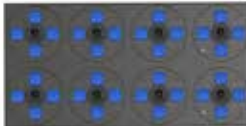
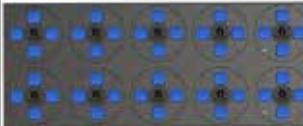

	400-450 mm	600 - 650 mm	800 - 850 mm	1000 - 1050 mm
SLD				
(1 row)	(2 sorter discs)	(3 sorter discs)	(4 sorter discs)	(5 sorter discs)
DLD				
(2 rows)	(4 sorter discs)	(6 sorter discs)	(8 sorter discs)	(10 sorter discs)

ZZ= “ZigZag” Diverter

The ZZ-Diverter is a high-speed sorter in which the deflection discs are arranged in a zigzag line. This design allows the sorting of small packages with a size of at least 80x80mm.

The following widths are available:

- 400 mm
- 600 mm
- 800 mm
- 1000 mm



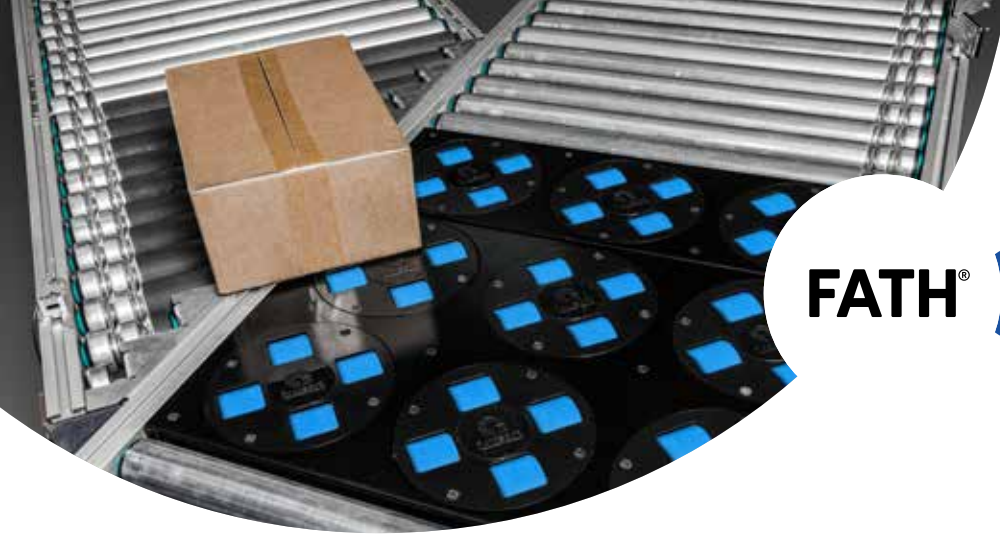

FATH®



flowsort
MODULAR SORTING SYSTEMS

	400 mm	600 mm	800 mm	1000 mm
ZZ (2 rows)	 (3 sorter discs)	 (6 sorter discs)	 (9 sorter discs)	 (12 sorter discs)
ZZ (4 rows)	 (6 sorter discs)	 (12 sorter discs)	 (18 sorter discs)	 (24 sorter discs)
ZZ (6 rows)	 (9 sorter discs)	 (18 sorter discs)	 (27 sorter discs)	 (36 sorter discs)
ZZ (8 rows)	 (12 sorter discs)	 (24 sorter discs)	 (36 sorter discs)	 (48 sorter discs)

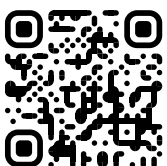

Would you like to learn more about
FlowSort Sorting systems?

diverter.fath24.com

FLWSORT® SINGLE LINE DIVERTER SLD

DESCRIPTION	For automated sorting of objects with a minimum size of 150 x 150 mm (e.g boxes, containers, cartons, envelopes, etc.) Easy and fast integration in all common conveyor systems Sorts in flow without abrupt movements, thus making it suitable also for sensitive goods Maximum layout flexibility due to stepless outfeed angles - 90° to +90° Plug & Play integration into all common PLC systems Retrofitting and scaling possible at any time Maximum sorting capacity: 6000 pieces / hour, depending on size of transported goods
MATERIAL	Rollers: Plastic TPU ≈ 70 Shore Case: Steel
SURFACE	Case: Laquered
COLOR	Rollers: Blue Case: Black
OPERATING VOLTAGE / FREQUENCY	24 V DC
PACK QUANTITY	1 piece
TIP	All widths between 400 - 450 mm, 600 - 650mm, 800 - 850 and 1000 - 1050 mm available
CONTROL	1 control card per row: Standard I/O via M8 connector Supported protocols: Profinet, Ethernet I/P, Modbus/TCP or EtherCAT
MAX. MASS CONVEYED GOOD (KG)	35 kg
MIN. MASS CONVEYED GOOD (KG)	0.05 kg
SPEED	Rotating speed: 180°/ 0.35 s Max. conveying speed: 1.5 m/s

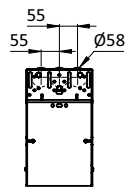
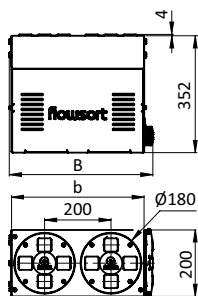

FLWSORT® SINGLE LINE DIVERTER SLD

Version	B [mm]	b [mm]	Weight [kg]	Part #
2 sorter discs	433	400	20.5	SLD400-200
	438	410	20.5	SLD410-200
	443	420	20.5	SLD420-200
	448	430	20.5	SLD430-200
	453	440	20.5	SLD440-200
	463	450	20.5	SLD450-200
3 sorter discs	633	600	28.5	SLD600-200
	638	610	28.5	SLD610-200
	643	620	28.5	SLD620-200
	648	630	28.5	SLD630-200
	653	640	28.5	SLD640-200
	663	650	28.5	SLD650-200
4 sorter discs	833	800	36.0	SLD800-200
	838	810	36.0	SLD810-200
	843	820	36.0	SLD820-200
	848	830	36.0	SLD830-200
	853	840	36.0	SLD840-200
	863	850	36.0	SLD850-200
5 sorter discs	1033	1000	43.5	SLD1000-200
	1038	1010	43.5	SLD1010-200
	1043	1020	43.5	SLD1020-200
	1048	1030	43.5	SLD1030-200
	1053	1040	43.5	SLD1040-200
	1063	1050	43.5	SLD1050-200

FLWSORT® DOUBLE LINE DIVERTER DLD

DESCRIPTION	For automated sorting of objects with a minimum size of 150 x 150 mm (e.g boxes, containers, cartons, envelopes, etc.) Easy and fast integration in all common conveyor systems Sorts in flow without abrupt movements, thus making it suitable also for sensitive goods Maximum layout flexibility due to stepless outfeed angles - 90° to +90° Plug & Play integration into all common PLC systems Retrofitting and scaling possible at any time Maximum sorting capacity: 6000 pieces / hour, depending on size of transported goods
MATERIAL	Rollers: Plastic TPU ≈ 70 Shore Case: Steel
SURFACE	Case: Laquered
COLOR	Rollers: Blue Case: Black
OPERATING VOLTAGE / FREQUENCY	24 V DC
PACK QUANTITY	1 piece
TIP	All widths between 400 - 450 mm, 600 - 650mm, 800 - 850 and 1000 - 1050 mm available
CONTROL	1 control card per row: Standard I/O via M8 connector Supported protocols: Profinet, Ethernet I/P, Modbus/TCP or EtherCAT
MAX. MASS CONVEYED GOOD (KG)	35 kg
MIN. MASS CONVEYED GOOD (KG)	0.05 kg
SPEED	Rotating speed: 180°/ 0.35 s Max. conveying speed: 1.5 m/s

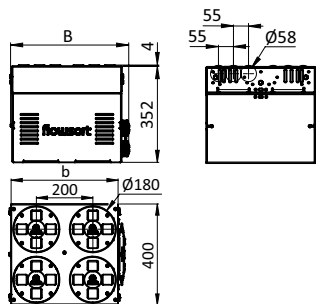

FLWSORT® DOUBLE LINE DIVERTER DLD

Version	B [mm]	b [mm]	Weight [kg]	Part #
4 sorter discs	433	400	36.0	DLD400-400
	438	410	36.0	DLD410-400
	443	420	36.0	DLD420-400
	448	430	36.0	DLD430-400
	453	440	36.0	DLD440-400
	453	450	36.0	DLD450-400
6 sorter discs	633	600	50.0	DLD600-400
	638	610	50.0	DLD610-400
	643	620	50.0	DLD620-400
	648	630	50.0	DLD630-400
	653	640	50.0	DLD640-400
	663	650	50.0	DLD650-400
8 sorter discs	833	800	62.0	DLD800-400
	838	810	62.0	DLD810-400
	843	820	62.0	DLD820-400
	848	830	62.0	DLD830-400
	853	840	62.0	DLD840-400
	863	850	62.0	DLD850-400
10 sorter discs	1033	1000	74.0	DLD1000-400
	1038	1010	74.0	DLD1010-400
	1043	1020	74.0	DLD1020-400
	1048	1030	74.0	DLD1030-400
	1053	1040	74.0	DLD1040-400
	1063	1050	74.0	DLD1050-400

FLOWSORT® ZICZAC DIVERTER ZZ

DESCRIPTION	For automated sorting of objects with a minimum size of 80 x 80 mm (e.g boxes, containers, cartons, envelopes, etc.) Easy and fast integration in all common conveyor systems Sorts in flow without abrupt movements, thus making it suitable also for sensitive goods Maximum layout flexibility due to stepless outfeed angles - 90° to + 90° Plug & Play integration into all common PLC systems Retrofitting and scaling possible at any time Maximum sorting capacity: 6000 pieces / hour, depending on size of transported goods
MATERIAL	Rollers: Plastic TPU ≈ 70 Shore Case: Steel
SURFACE	Case: Laquered
COLOR	Rollers: Blue Case: Black
OPERATING VOLTAGE / FREQUENCY	24 V DC
PACK QUANTITY	1 piece
CONTROL	1 homing sensor per row 1 control card per row: Standard I/O via M8 connector Supported protocols: Profinet, Ethernet I/P, Modbus/TCP or EtherCAT
MAX. MASS CONVEYED GOOD (KG)	35 kg
MIN. MASS CONVEYED GOOD (KG)	0.05 kg
SPEED	Rotating speed: 180°/ 0.35 s Max. conveying speed: 1.5 m/s

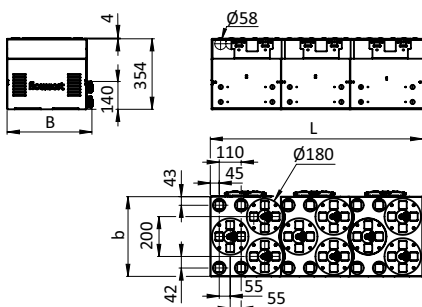

	Version	B [mm]	b [mm]	L [mm]	Weight [kg]	Part #
	2 rows, 3 sorter discs	426	400	373.2	36.0	ZZ400-2
	4 rows, 6 sorter discs	426	400	719.6	70.0	ZZ400-4
	6 rows, 9 sorter discs	426	400	1066	105.0	ZZ400-6
	8 rows, 12 sorter discs	426	400	1412	140.0	ZZ400-8
	2 rows, 6 sorter discs	626	600	373.2	51.0	ZZ600-2
	4 rows, 12 sorter discs	626	600	719.6	100.0	ZZ600-4
	6 rows, 18 sorter discs	626	600	1066	150.0	ZZ600-6
	8 rows, 24 sorter discs	626	600	1412	200.0	ZZ600-8
	2 rows, 9 sorter discs	826	800	373.2	72.0	ZZ800-2
	4 rows, 18 sorter discs	826	800	719.6	140.0	ZZ800-4
	6 rows, 27 sorter discs	826	800	1066	210.0	ZZ800-6
	8 rows, 36 sorter discs	826	800	1412	280.0	ZZ800-8
	2 rows, 12 sorter discs	1026	1000	371.2	80.0	ZZ1000-2
	4 rows, 24 sorter discs	1026	1000	719.6	158.0	ZZ1000-4
	6 rows, 36 sorter discs	1026	1000	1066	230.0	ZZ1000-6
	8 rows, 48 sorter discs	1026	1000	1412	310.0	ZZ1000-8

ELECTRIC MOTOR FOR FLOWSORT® DIVERTERS

MODEL	Compatible with SLD, DLD and ZZ diverters
DESCRIPTION	Durable casing Low energy consumption M8 - 4 Pin connector
OPERATING VOLT-AGE / FREQUENCY	24 V DC
OPERATING CURRENT	2,5 A - 3,5 A
OPERATING TEMPERATURE	-10 °C - + 40 °C
IP RATING	IP54
PACK QUANTITY	1 piece
POWER OUTPUT	40 - 50 W

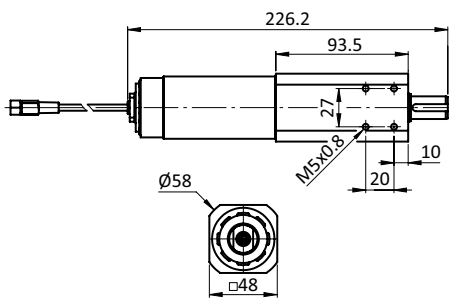

	Version	Weight [kg]	Part #
	Drive motor for conveyor roller	1.3	E000001
	Control motor for disc module	1.3	E000002

CONTROL UNIT CONVEYLINX-AI2 FOR FLOWSORT® DIVERTERS

MODEL	Compatible with SLD, DLD and ZZ diverters
DESCRIPTION	Control of up to 2 motors and 2 sensors Supported protocols: Profinet, ethernet I/P, modbus/TCP, etherCAT Product tracking data handling for easier PLC programming Completely programmable and configurable M8 female connector for connecting npn- or pnp phototransistors, M8 male connector for connecting motors Durable casing
OPERATING VOLT-AGE / FREQUENCY	24 V DC
IP RATING	IP54
PACK QUANTITY	1 piece

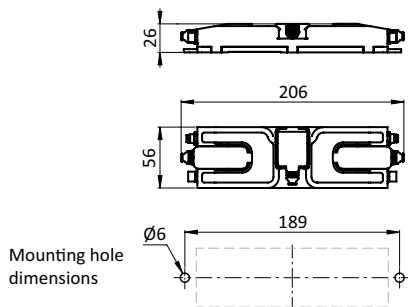

Weight [kg]	Part #
0.2	E000003

CONTROL UNIT MOTIONLINX-AI FOR FLOWSORT® DIVERTERS

MODEL	Compatible with SLD, DLD and ZZ diverters
DESCRIPTION	Control of up to 2 motors and 2 sensors, Supported protocols: EtherCAT M8 female connector for connecting npn- or pnp phototransistors, M8 male connector for connecting motors Motor error detection Adjustable acceleration and deceleration Durable casing
OPERATING VOLTAGE / FREQUENCY	24 V DC
IP RATING	IP54
PACK QUANTITY	1 piece

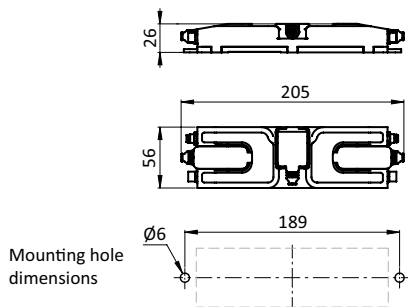

Weight [kg]	Part #
0.2	E000004

INDUCTIVE POSITION SENSOR FOR FLOWSORT® DIVERTERS

MODEL	Compatible with SLD, DLD and ZZ diverters
DESCRIPTION	Ready-to-use position sensor M12 thread for fastening and positioning Without connection cable
PACK QUANTITY	1 piece



Weight [g]	Part #
27	E000005

WHEEL DRIVE ASSEMBLY FOR FLOWSORT® DIVERTERS

MODEL	Compatible with SLD, DLD and ZZ diverters
DESCRIPTION	Ready to use wheel drive assembly
MATERIAL	Cover Plate: Steel Frame: Plastic POM Rollers: Plastic TPU Bevel gear: Plastic POM
SURFACE	Cover plate: Laquered
COLOR	Frame: Black Rollers: Blue
PACK QUANTITY	1 piece

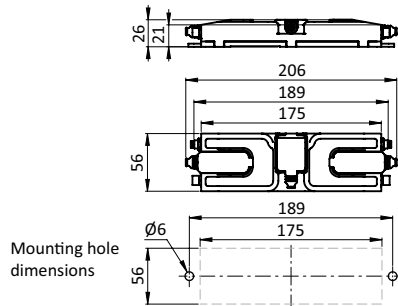

Weight [g]	Part #
930	S000003

PULLEY DRIVE ASSEMBLY FOR FLOWSORT® DIVERTERS

MODEL	Compatible with SLD, DLD and ZZ diverters
DESCRIPTION	Ready to install pulley drive assembly Compound of pulleys, bevel gear and axles
MATERIAL	Large Pulley: Aluminum Small pulley: Steel Bevel gear: Plastic POM Hollow axles: Steel
PACK QUANTITY	1 piece



Weight [g]	Part #
810	S000004

BEVEL GEAR FOR FLOWSORT® DIVERTERS

MODEL	Compatible with SLD, DLD and ZZ diverters
DESCRIPTION	Bevel Gear with Ø 10 mm diameter for drive of conveyor rollers, With keyway 3 x 3 mm
MATERIAL	Plastic POM
PACK QUANTITY	1 piece

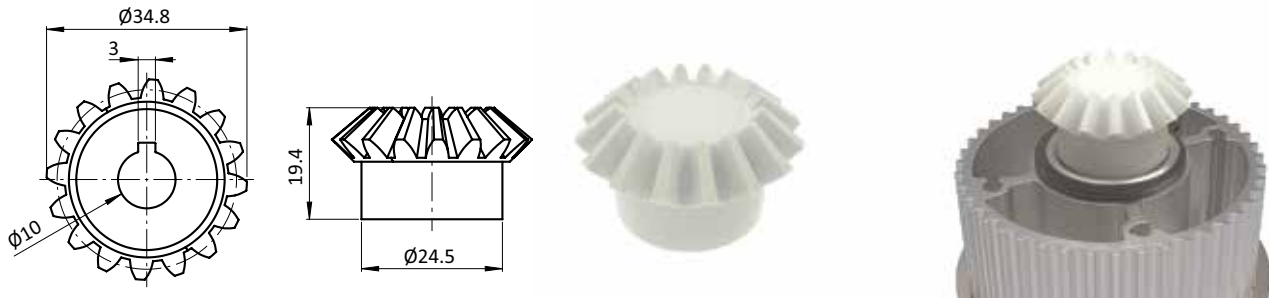

Weight [g]	Part #
11	I000005

TIMING BELT TENSIONER ELEMENT FOR FLOWSORT® DIVERTERS

MODEL	Compatible with SLD, DLD and ZZ diverters
DESCRIPTION	Ready to use belt tensioner element
MATERIAL	Tensioning unit: Steel Tensioner pulley: Aluminum
PACK QUANTITY	1 piece



Version	Weight [g]	Part #
Timing Belt Tensioner Element	144	S000023

TIMING BELT TENSIONER ELEMENT REVERS FOR FLOWSORT® DIVERTERS

MODEL	Compatible with SLD, DLD and ZZ diverters
DESCRIPTION	Ready to use belt tensioner element
MATERIAL	Tensioning unit: Steel Tensioner pulley: Aluminum
PACK QUANTITY	1 piece



Weight [g]	Part #
148	S000027

CONTROL BELT FOR FLOWSORT® DIVERTERS

MODEL	Compatible with SLD, DLD and ZZ diverters
DESCRIPTION	Belt for direction control
PACK QUANTITY	1 piece



	Weight [g]	Part #
	11	V000005

TRANSMISSION BELT DIRECTION CONTROL FOR FLOWSORT® DIVERTERS

MODEL	Compatible with SLD, DLD and ZZ diverters
DESCRIPTION	Transmission belt for control pulses for wheel drive assembly
PACK QUANTITY	1 piece



	Weight [g]	Part #
	21	V000029

DRIVE BELT FOR FLOWSORT® DIVERTERS

MODEL	Compatible with SLD, DLD and ZZ diverters
DESCRIPTION	Timing belt for motion control
PACK QUANTITY	1 piece



	Weight [g]	Part #
	10	V000028

TRANSMISSION BELT WHEEL DRIVE FOR FLOWSORT® DIVERTERS

MODEL	Compatible with SLD, DLD and ZZ diverters
DESCRIPTION	Transmission belt for wheel drive
PACK QUANTITY	1 piece

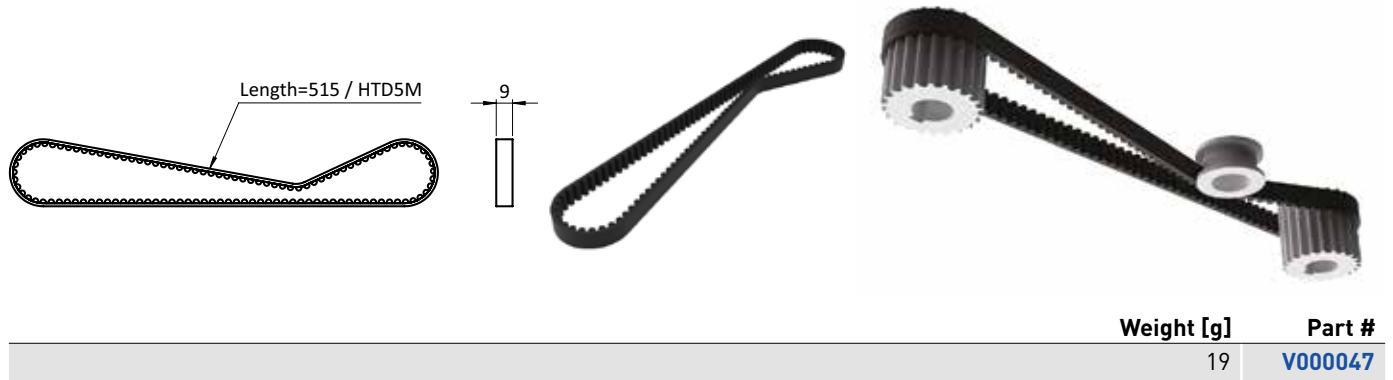

PART NUMBER INDEX

02		02052A5L75	48	DLD1000-400	66	V000047	80
02021N35G	54	02052E02A1-3R01	52	DLD1010-400	66	ZZ	
02021N45G	54	02052E02A4A5PR01	52	DLD1020-400	66	ZZ400-2	67
02021N75G	54	02052E02AR02	52	DLD1030-400	66	ZZ400-4	67
0203HF09093	28	02052E03A1-301	51	DLD1040-400	66	ZZ400-6	67
0203HI05093	25	02052E03A4P	51	DLD1050-400	66	ZZ400-8	67
0203HI07593	26	02052E03A5L	51	E		ZZ600-2	67
0203HI10093	27	02052E04A1-301	51	E000001	68	ZZ600-4	67
0203HL05093	23	02052E04A4P	51	E000002	68	ZZ600-6	67
0203HL07593	24	02052E04A5L	51	E000003	69	ZZ600-8	67
0203HT05093	21	0206BM31	55	E000004	70	ZZ800-2	67
0203HT07593	22	0206BM55	55	E000005	71	ZZ800-4	67
0203T05056	18	0206BM63	55	I		ZZ800-6	67
0203T05093	18	0206BM91	55	I000005	74	ZZ800-8	67
0203T07593	19	0206FP91	57	S		ZZ1000-2	67
0203T10056	20	0206U200CS	56	S000003	72	ZZ1000-4	67
0203T10093	20	02064A3N0874	44	S000004	73	ZZ1000-6	67
0203WRA1/215	32	02064A4N0874	44	S000023	75	ZZ1000-8	67
0203WRA1/231	32	02064OSN0874	44	S000027	76		
0203WRA1/255	32	06		SLD			
0203WRA1/263	32	062IA3572	15	SLD400-200	64		
0203WRA1/293	32	062IHD40M	14	SLD410-200	64		
0203WRA1/393	30	062IHSD40M	14	SLD420-200	64		
0203WRA493	31	062MG36MS01	12	SLD430-200	64		
0203WRA593	29	062XHD40M	11	SLD440-200	64		
02041A315	34	062XHSD40M	11	SLD450-200	64		
02041A355	34	6		SLD600-200	64		
02041A363	34	6IPR1591ESD.4000S01	13	SLD610-200	64		
02041A375	34	09		SLD620-200	64		
02041A391	34	093003S01	10	SLD630-200	64		
02041A393	34	DLD		SLD640-200	64		
02041A415	33	DLD400-400	66	SLD650-200	64		
02041A455	33	DLD410-400	66	SLD800-200	64		
02041A463	33	DLD420-400	66	SLD810-200	64		
02041A475	33	DLD430-400	66	SLD820-200	64		
02041A491	33	DLD440-400	66	SLD830-200	64		
02041A493	33	DLD450-400	66	SLD840-200	64		
02042AT	41	DLD600-400	66	SLD850-200	64		
02042CC	35	DLD610-400	66	SLD1000-200	64		
02042CM	43	DLD620-400	66	SLD1010-200	64		
02042HH	36	DLD630-400	66	SLD1020-200	64		
02042KC	42	DLD640-400	66	SLD1030-200	64		
02042MH	40	DLD650-400	66	SLD1040-200	64		
02042PC	39	DLD800-400	66	SLD1050-200	64		
02042SE	37	DLD810-400	66	V			
02042SH	38	DLD820-400	66	V000005	77		
02051A4LS01	53	DLD830-400	66	V000028	79		
02051A4PS01	53	DLD840-400	66	V000029	78		
02051A5LS01	53	DLD850-400	66				
02051A5PS01	53						
02052A1/375	49						
02052A4P75	50						

ALPHABETICAL INDEX

A	
Aluminum Tube (Set)	41
B	
Bevel Gear for Flowsort® Diverters	74
Board Marker with Felt Eraser (Set)	55
C	
Ceiling Magnet with Hook	43
Cleaning Spray for Board Marker	56
Closing Clip	35
Connector for Roller Track ST / XST	12
Control Belt for Flowsort® Diverters	77
Control Unit ConveyLinx-Ai2 for Flowsort® Diverters	69
Control Unit MotionLinx-Ai for Flowsort® Diverters	70
D	
Docking Clip I 60x24	15
Drive Belt for Flowsort® Diverters	79
E	
Electric Motor for Flowsort® Diverters	68
F	
Floor Marking Foot Shape 90	28
Floor Marking I-shape 50	25
Floor Marking I-shape 75	26
Floor Marking I-shape 100	27
Floor Marking L-shape 50	23
Floor Marking L-shape 75	24
Floor Marking Tape 50	18
Floor Marking Tape 75	19
Floor Marking Tape 100	20
Floor Marking T-shape 50	21
Floor Marking T-shape 75	22
Floor Window 1/2 DIN A4 Landscape - 11.7" x 4.1"	32
Floor Window 1/3 DIN A4 Portrait - 8.3" x 3.9"	30
Floor Window DIN A4 - 8.3" x 11.7"	31
Floor Window DIN A5 - 5.8" x 8.3"	29
Flowsort® Double Line Diverter DLD	65
Flowsort® Single Line Diverter SLD	63
Flowsort® ZicZac Diverter ZZ	67
H	
Hanging Hook	36
Holding Bracket I 60x24 40	14
Holding Bracket ST / XST 40	11
I	
Inductive Position Sensor for Flowsort® Diverters	71
Inserting Box 1/3 DIN A4 Portrait - 8.3" x 3.9"	49
Inserting Box DIN A4 Portrait - 8.3" x 11.7"	50
Inserting Box DIN A5 Landscape - 8.3" x 5.8"	48

ALPHABETICAL INDEX

K	
KANBAN Wall Bracket for Inserting Boxes	52
Knotted Chain	42
M	
Magnet for Inserting Systems (Set)	54
Message Frame DIN A3 - 11.7" x 16.5" (Set)	34
Message Frame DIN A4 - 8.3" x 11.7" (Set)	33
P	
Pulley Drive Assembly for Flowsort® Diverters	73
R	
Refill Felt Pad for Eraser, Self-adhesive	57
Roller Track I 60x24	13
S	
S-hook	38
Sign Holder AL (Set)	44
Swivel Loop	37
Swivel Magnet Holder	40
T	
Timing Belt Tensioner Element for Flowsort® Diverters	75
Timing Belt Tensioner Element Revers for Flowsort® Diverters	76
Tool Hanger 8	10
Transmission Belt Direction Control for Flowsort® Diverters	78
Transmission Belt Wheel Drive for Flowsort® Diverters	80
Tube Clamp	39
W	
Wall File Pocket	53
Wheel Drive Assembly for Flowsort® Diverters	72
Window for Inserting Boxes	51

FATH GmbH | INNOVATIONS@**FATH** 22|FEB

FATH GmbH | Gewerbepark Hügelmühle 31, 91174 Spalt, Germany
P: +49 9175 7909-200 | F: +49 9175 7909-29 | info.de@fath24.com | fath24.com

Managing Directors: Mirko Jan **FATH**, Wido **FATH**
Trade Register: Amtsgericht Nürnberg, Department B, No. 10906
Place of Execution: 91174 Spalt, Germany
Tax No.: 241/115/40086, VAT No.: DE 133 541 653

© **FATH** GmbH

Reprinting or other duplication, including excerpts, is possible only with the express permission of **FATH** GmbH.
We reserve the right to make technical modifications at any time. All indications are without guarantee.
Drawings and models are the intellectual property of **FATH** GmbH.
Our current Terms and Conditions of Sale, Delivery and Payment apply.

Illustrations: Andreas Teindl, Dipl. Designer, Illustrator IO

FATH GmbH

Gewerbepark
Hügelmühle 31
91174 Spalt
Germany

P: +49 9175 7909-200
F: +49 9175 7909-29
info.de@fath24.com

FATH Inc.

6533 Hazeltine National
Drive,
Suite 3
Orlando, FL 32822
USA

P: +1 407 601-5900
F: +1 407 601-5905
info.us@fath24.com

**FATH Machine Components
Co., Ltd**

Shengang Road No. 2001,
Building 2
201612 Songjiang / Shanghai
PR China

P: +86 21 5774 4520
info.cn@fath24.com

FATH Kft.

Gyár u. 2.
2040 Budaörs
Hungary

P: +36 23 880-977
F: +36 23 880-978
info.hu@fath24.com

FATH Ltd.

6 Pegasus Court, North
Lane
Aldershot
Hampshire
GU12 4QP
Great Britain

P: +44 1252 346610
info.gb@fath24.com

FATH Inc. S.A. de C.V.

Av. Central 230, Int. 140
Los Lermas
67188 Guadalupe, N.L.
Mexico

P: +52 81 3424-1428
info.mx@fath24.com

**FATH do Brasil Componen-
tes Industriais Ltda**

Rodovia Raposo Tavares,
S/N, Km 22,14 Bloco E - 509
Granja Viana.
Cotia - SP
06709 - 900
Brazil

P: +55 11 2898-9753
info.br@fath24.com

FATH BV

Rudolf Dieselweg 14
5928 RA Venlo
The Netherlands

P: +31 77 333 35 55
F: +31 77 333 35 50
info.nl@fath24.com

FATH Schweiz AG

Driesbüelstraße 11
8808 Pfäffikon
Switzerland

P: +41 79 577 61 97
info.ch@fath24.com

ambos.io GmbH

Wetterkreuz 15
91053 Erlangen
Germany

P: +49 9131 9279180
info@ambos.io

Flowsort BV

Hooge Akker 18
5661 NG Geldrop
The Netherlands

P: +31 85 0761339
info.@flow-sort.com

Bestell-Nr. 000313



161610